

Battery Energy Storage System **PowerX**

Quick Installation Guide

1. Product Overview

Battery Appearance

The battery is applicable to the grid-tied or off-grid systems of residential rooftop PV plants. It can store and release electric energy based on service requirements.

NOTE – The 15 kWh model is used as an example.

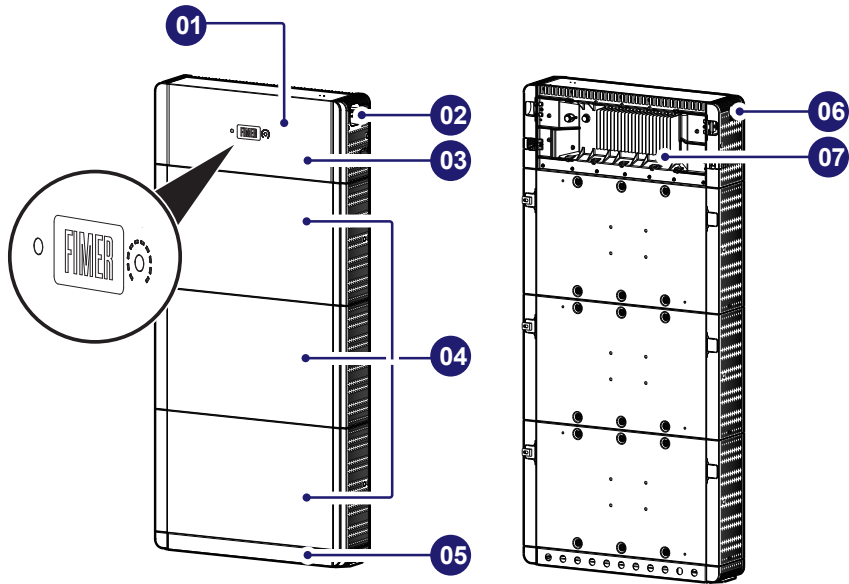

Power Control Module and Battery Expansion

01	LED indicators	05	Mounting base
02	DC switch (DC SWITCH)	06	Black start switch
03	Charger	07	Heat sink
04	Battery expansion modules		

Modules

The battery consists of a power control module and battery expansion modules. The power control module is 5 kW, and a battery expansion module has a standard capacity of 5 kWh.

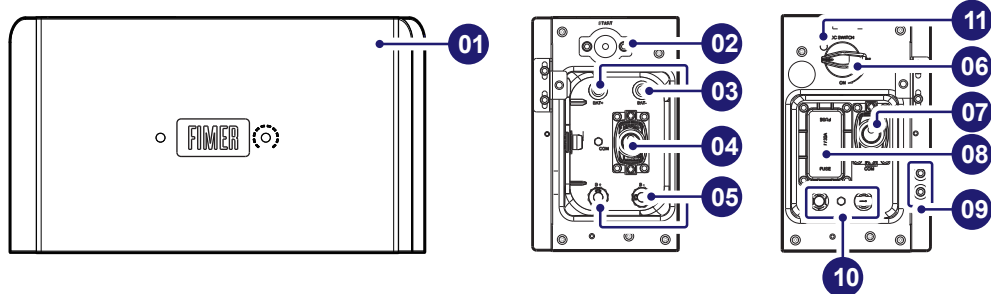

01 Charger	05 Battery cascading terminals (B+/B-)	09 Ground points
02 Black start switch	06 DC switch (DC SWITCH)	10 Battery terminals (BAT-/BAT+)
03 Battery terminals (BAT+/BAT-)	07 COM port (COM)	11 DC switch locking screw hole (M4) ^a
04 COM port (COM)	08 Fuse	

NOTE – A: (Optional) Remove the protective cap and install the locking screw that secures the DC SWITCH to prevent misoperations.

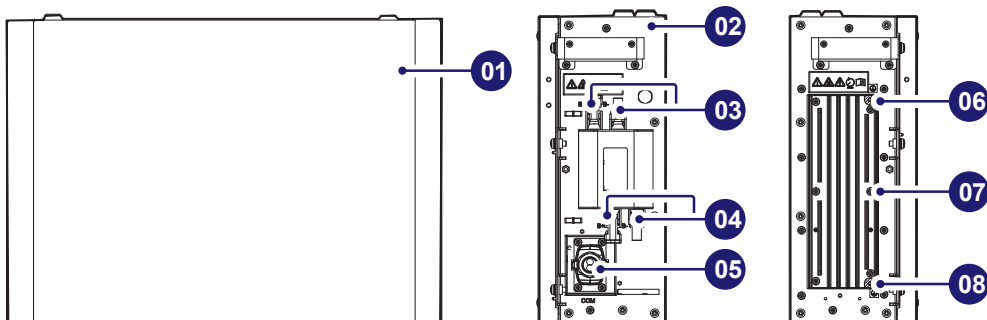

01 Battery expansion module	05 COM port (COM)
02 Bosses for alignment	06 Ground point
03 Battery cascading terminals (B+/B-)	07 Heat sink
04 Battery cascading terminals (B+/B-)	08 Ground point

NOTE – a: (Optional) Remove the plastic cap and install a locking screw for the DC switch to prevent misoperations.

Battery Capacity Description

The battery supports power and capacity expansion. Two power control modules can be connected in parallel. One power control module supports a maximum of three battery expansion modules.

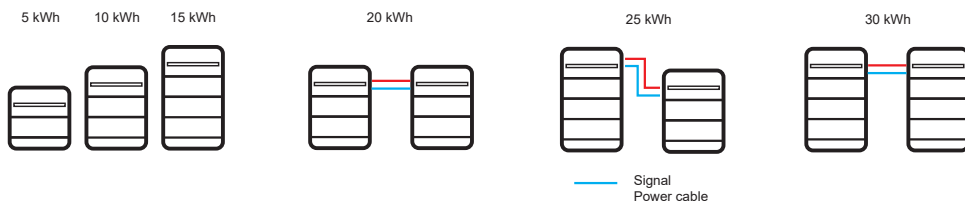

2. Device Installation

2.1 Installation Requirements

Installation Environment

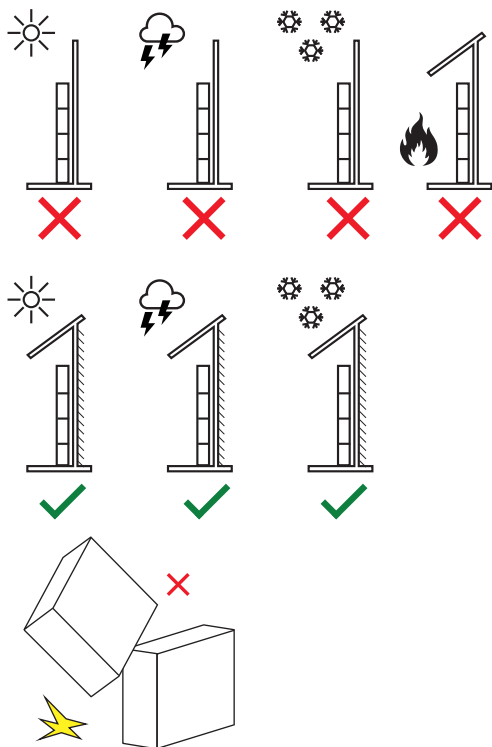

⚠ WARNING – Do not use a dropped battery module or a battery module that has been subjected to a strong impact force. Otherwise, safety risks (such as cell leakage and electric shock) may arise.

Installation Environment Requirements

The installation and usage environment must meet relevant international, national, and local standards for lithium batteries, and are in accordance with the local laws and regulations. The user is obliged to protect the battery against fire or other hazards.

Ensure that the battery is not accessible to children and away from daily working or living areas, including but not limited to the following areas: studio, bedroom, lounge, living room, music room, kitchen, study, game room, home theater, sunroom, toilet, bathroom, laundry, and attic.

When installing the battery in a garage, keep it away from the drive way. It is recommended that the battery be mounted on the wall higher than the bumper to prevent collision.

Do not install the battery in places that are enclosed, unventilated, without proper fire fighting facilities, or difficult for firefighters to access. Do not place flammable or explosive materials around the battery. It is recommended that the battery be mounted on a wall to avoid contact with water.

Install the battery in a dry and well-ventilated environment. Secure the battery on a solid and flat surface.

Install the battery in a sheltered place or install an awning over it to avoid direct sunlight or rain.

Install the battery in a clean environment that is free from sources of strong infrared radiation, organic solvents, and corrosive gases.

For areas prone to natural disasters such as floods, debris flows, earthquakes, and typhoons/hurricanes, take corresponding precautions for installation.

Keep the battery away from fire sources. Do not place any flammable or explosive materials around the battery.

Keep the battery away from water sources such as taps, sewer pipes, and sprinklers to prevent water see page.

Do not install the battery in a position where it is easy to touch as the temperature of the chassis and heat sink is high when the battery is running.

To prevent fire due to high temperature, ensure that the vents and the cooling system are not blocked when the battery is running.

Do not expose the battery to flammable or explosive gas or smoke. Do not perform any operation on the battery in such environments.

Do not install the battery on a moving object, such as ship, train, or car.

In backup power scenarios, do not use the battery for the following situations

- a. Medical devices substantially important to human life.
- b. Control equipment such as trains and elevators, which may cause **personal injury**.
- c. Computer systems of social and public importance.
- d. Locations near medical devices.
- e. Other devices similar to those described above.

Do not install the battery outdoors in salt-affected areas because it may corrode. A salt-affected area refers to the region within 500 meters from the coast or prone to sea breeze. The regions prone to sea breeze vary with weather conditions (such as typhoons and monsoons) or terrains (such as dams and hills).

Mounting Hole Dimensions

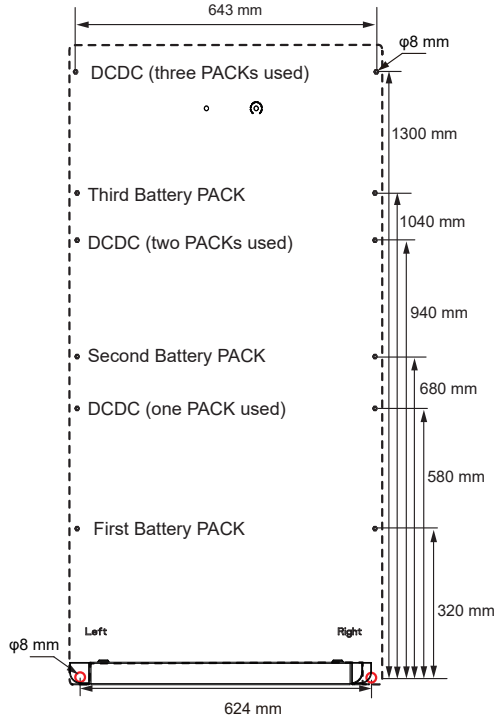
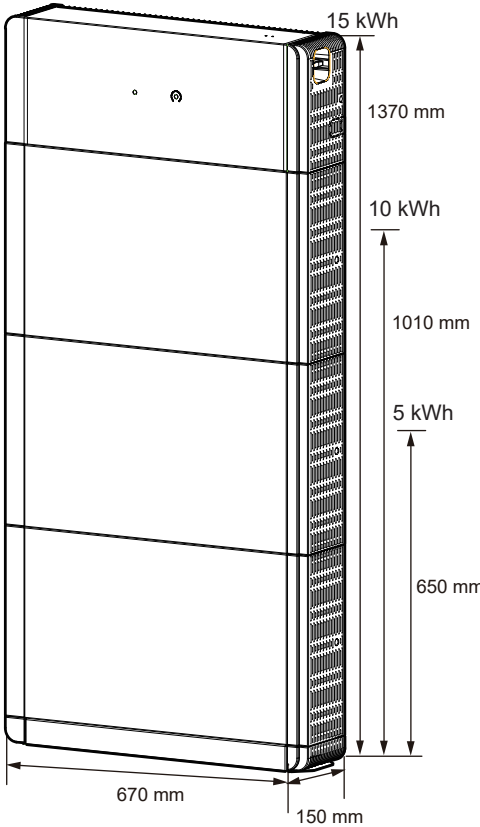

2.2 Installing the Floor Support

WARNING – Avoid drilling holes in the water pipes and cables buried in the wall.

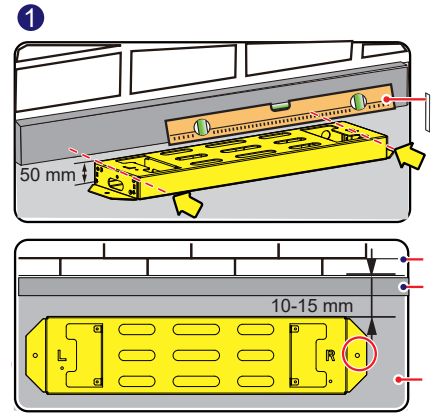

2

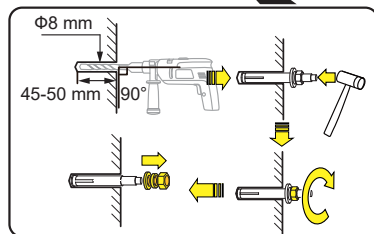
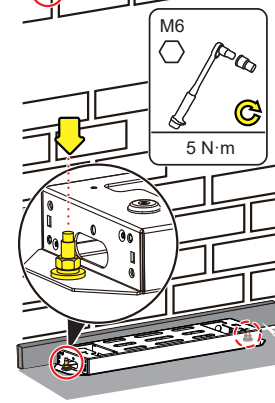
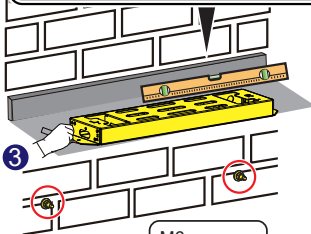
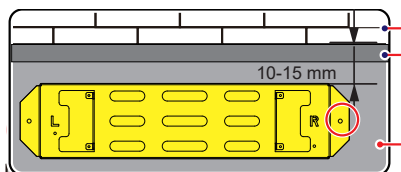
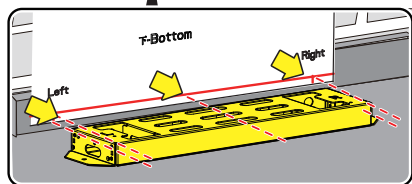
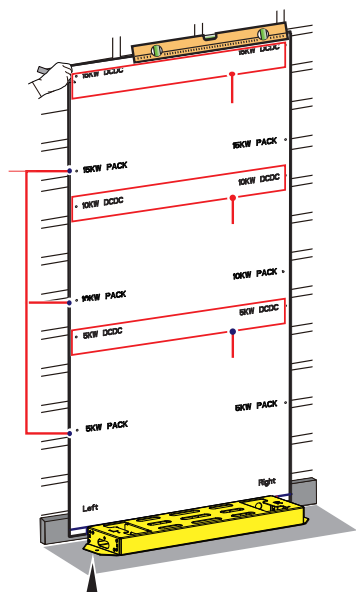

NOTE – The M6x60 expansion bolts delivered with the battery are mainly used for solid concrete walls and concrete floors. If other types of walls and floors are used, ensure that the walls and floors meet the load-bearing requirements (one battery expansion module weighs 50kg) and select the bolts by yourself.

NOTE – The power control module (DCDC) must be fixed on the wall. If the device is installed in an areaprone to earthquakes or vibration, you can mark the battery module mounting holes and drillholes to install expansion bolts in step 2.

2.3 Installing Battery Expansion Modules

1. Install the battery expansion modules and power control module on the support.

NOTE – The following describes how to install the battery expansion modules for a 15 kWh model.

NOTE – The installation of battery expansion modules for 5 kWh and 10 kWh models is the same. One battery expansion module is installed for a 5 kWh model, and two battery expansion modules are installed for a 10 kWh model.

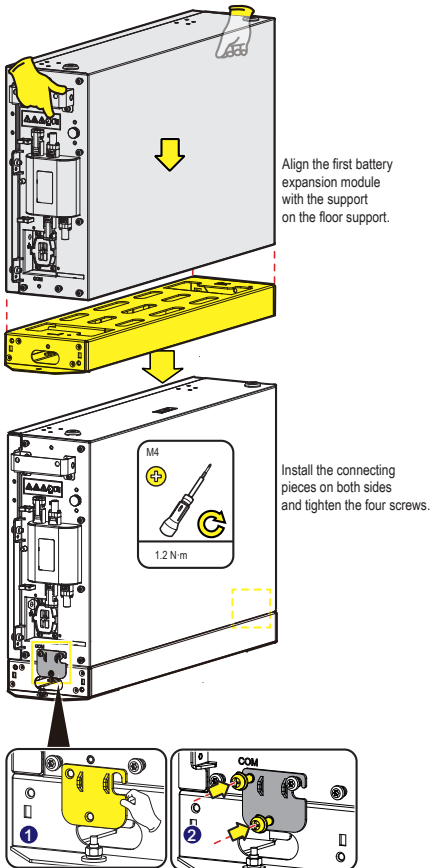

Install the remaining battery expansion modules and power control module from bottom to top.

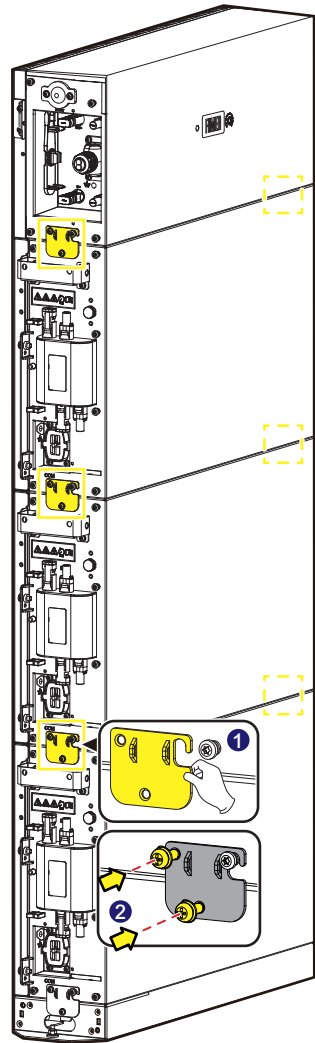

2. Secure the power control module to the wall.

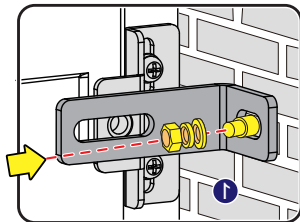

2.4 Wall-mounted Installation

Mounting Hole Dimensions

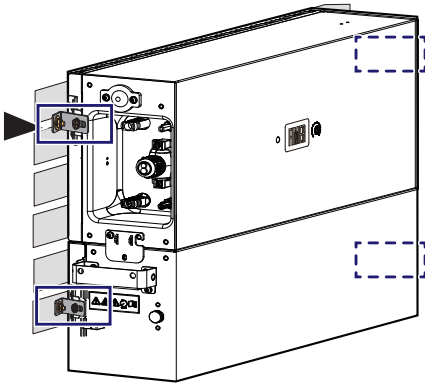
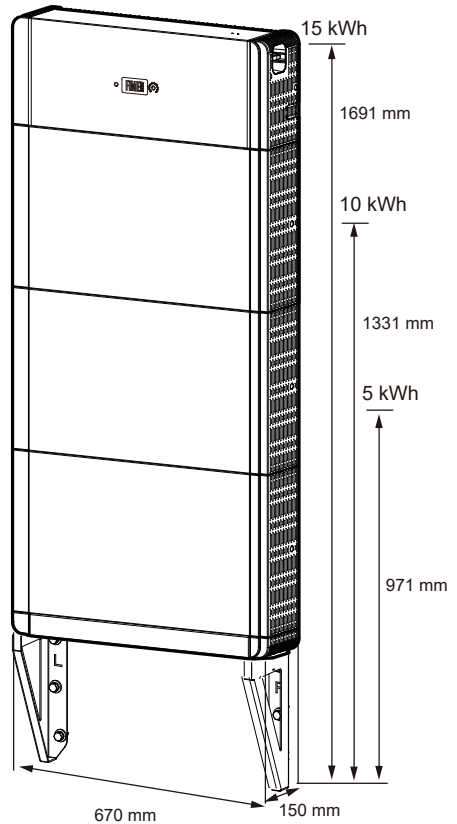
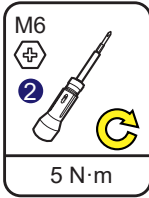
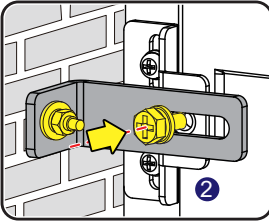
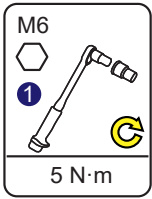

3. (Optional) Secure the battery expansion modules to the wall by referring to step 2.

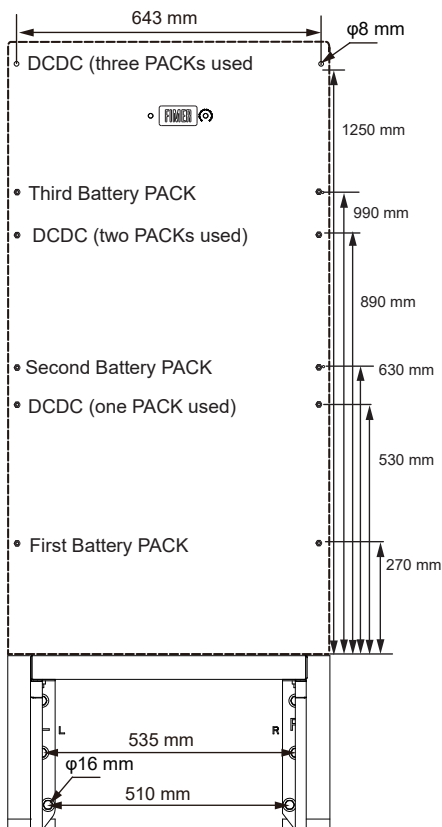

Installing the Support for Wall-mounted Installation

NOTE – For floor-mounted installation, the base is 50 mm high. If waterproofing requirements cannot be met, the battery can be installed on a wall. The mounting kits need to be purchased separately. For wall-and floor-mounted installation, ensure that the load-bearing capacity meets the requirements (one battery expansion module weighs 50 kg).

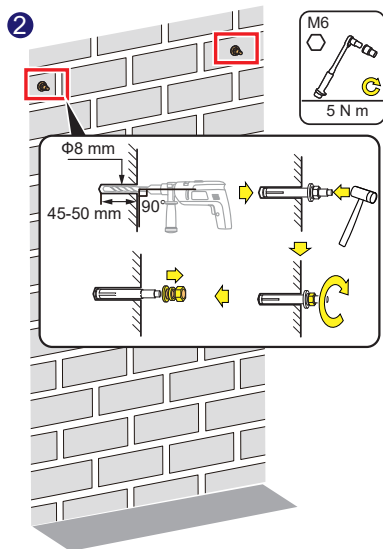
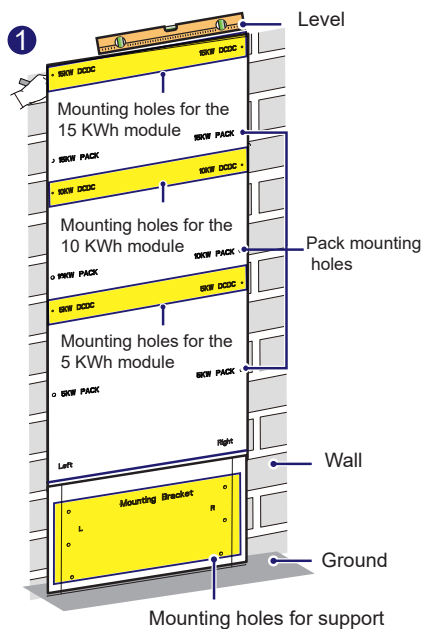

3

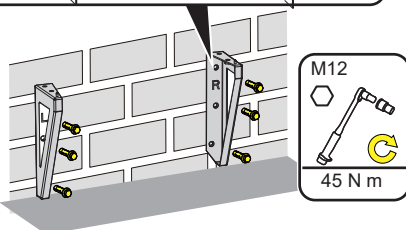
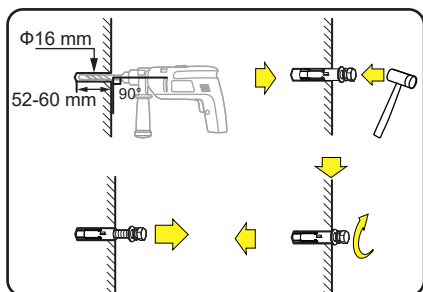

4

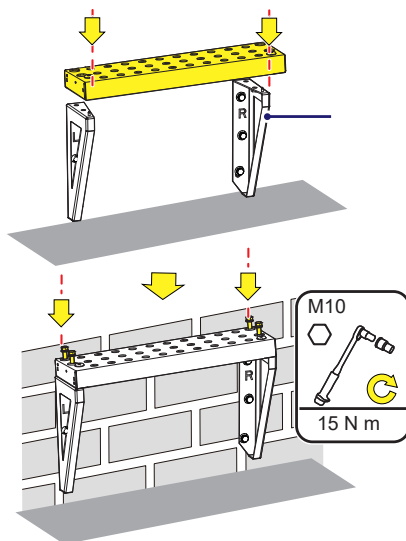

3. Internal Electrical Connections of the Battery

NOTE – Connect cables in accordance with local installation laws and regulations.

NOTE – Before connecting cables, ensure that the DC switch on the battery and all the switches connected to the battery are set to OFF. Otherwise, the high voltage of the battery may result in electric shocks.

3.1 Installing an Internal Ground Cable

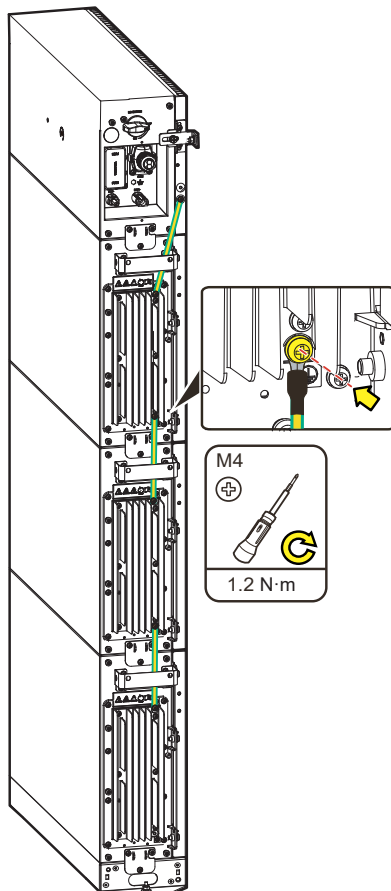

3.2 Installing Internal DC Terminals

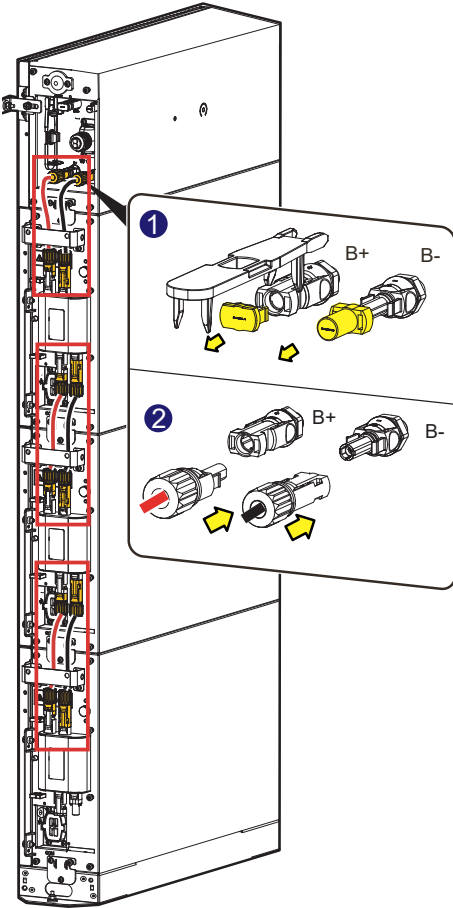

NOTE – Internal electrical cables are delivered with the battery, see the Packing List in the packing case.

NOTE – The Amphenol terminal is used as the DC terminal between the power control module and the battery expansion modules.

3.3 Connecting Internal Signal Cables

NOTE – The protective housing of the communications terminal delivered with the device can be fastened with clips or screws based on the actual diagram.

NOTE – Install signal cables with a diameter of 5 mm and rubber plugs as described in this section. Do not use signal cables with a diameter of 7 mm.

Securing With Clips

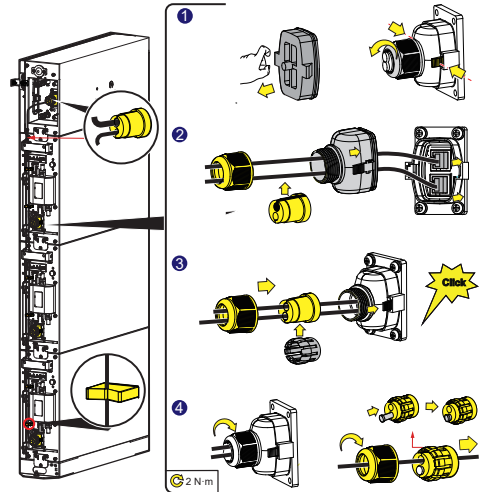

NOTE – When a communications terminal is connected to a single network cable, a waterproof rubberplug must be installed. Do not install a cable with a diameter of 5 mm into a $\Phi 7$ mm rubber plug.

NOTE – After inserting the terminal shell into the COM port, shake the terminal shell left and right and pull it back to ensure that it is securely installed, and tighten the nut (ensure that the rubber plug is tightly compressed). Otherwise, the waterproof performance is affected.

Securing With Screws

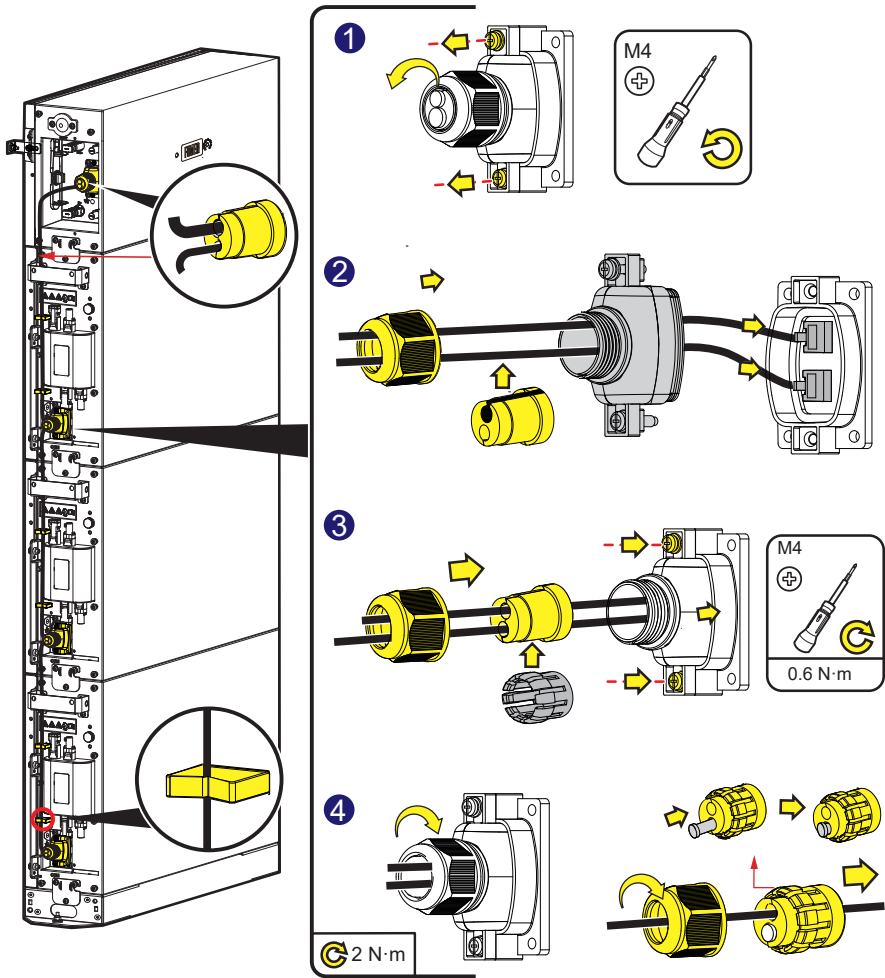

NOTE – When a communications terminal is connected to a single network cable, a waterproof rubber plug must be installed. Do not install a cable with a diameter of 5 mm into a $\Phi 7$ mm rubber plug.

NOTE – After inserting the terminal shell into the COM port, shake the terminal shell left and right and pull it back to ensure that it is securely installed, and tighten the nut (ensure that the rubber plug is tightly compressed). Otherwise, the waterproof performance is affected.

4. External Electrical Connections of the Battery

4.1 Preparing Cables

⚠ WARNING – Before connecting cables, ensure that the DC switch on the battery and all the switches connected to the battery are set to OFF. Otherwise, the high voltage of the battery may result in electric shocks.

- 📌 NOTE** – • Connect cables in accordance with local installation laws and regulations.
- 📌 NOTE** – The DC input power cable and signal cable between the battery and the inverter must be less than or equal to 10 m.

Prepare cables based on site requirements.

Nr	Cable	Type	Conductor Cross-Sectional Area Range	Outer Diameter
1	Ground cable	Single-core outdoor copper-core cable	10 mm ²	-
2	DC input power cable (inverter to battery and battery to battery)	Common outdoor PV cable in the industry	4–6 mm ²	5.5–9 mm
3	Signal cable (inverter to battery and battery to battery)	Outdoor shielded twisted pair cable (8 cores)	0.20–1 mm ²	6.2–7 mm

4.2 Routing Cables Out of the Cable Hole

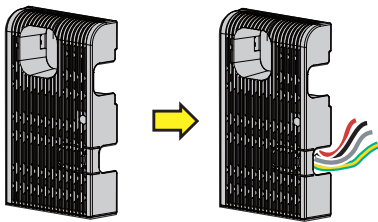

📌 NOTE – Before connecting external cables, route the cables through the cable hole to avoid disconnecting after installation.

4.3 Installing a Ground Cable

- 📌 NOTE** – Ground a ground point of the power control module.
- 📌 NOTE** – Apply silica gel or paint around the ground terminal after the ground cable is connected.

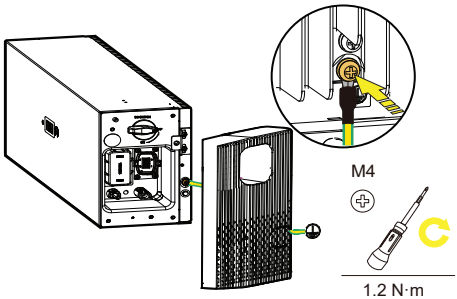

4.4 Installing DC Input Power Cables

- 📌 NOTE** – 1. You are advised to connect the battery terminals (BAT+ and BAT–) on the switch side to the inverter and connect the other side to the cascaded battery.
- 📌 NOTE** – 2. The battery terminals use the Staubli MC4 positive and negative metal terminals and DC connectors supplied with the solar inverter. Using incompatible positive and negative metal terminals and DC connectors may result in serious consequences. The caused device damage is not covered under warranty.

Assembling DC Connectors

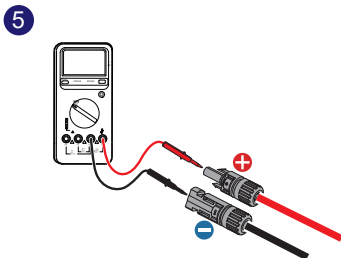
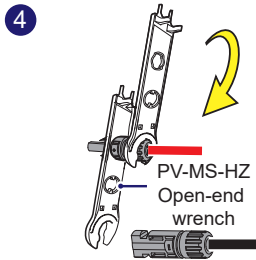
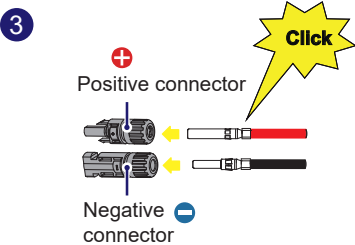
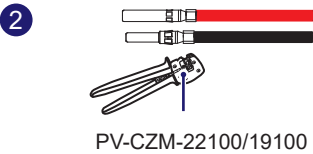
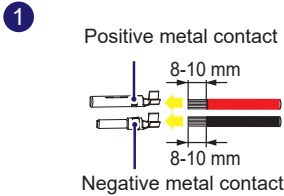

Installing DC Input Power Cables

WARNING – Use dedicated insulated tools to connect cables. Ensure that

battery cables are connected to correct polarities. If the battery cables are reversely connected, the battery may be damaged.

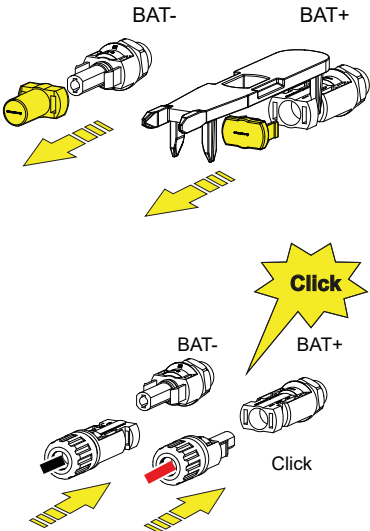
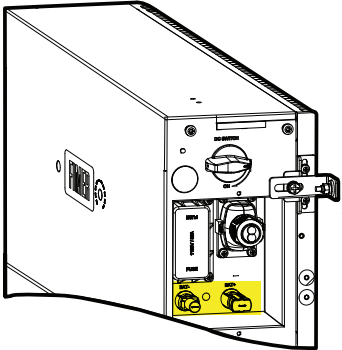

4.5 Installing a Signal Cable

- NOTE** – When laying out a signal cable, separate it from power cables and keep it away from strong interference sources to prevent communication interruption.
- NOTE** – Ensure that the protection layer of the cable is inside the connector, that excess core wires are cut off from the protection layer, that the exposed core wire is totally inserted into the cable hole, and that the cable is connected securely.

NOTE – Use a plug to block the idle cable hole with the waterproof rubber ring, and then tighten the locking cap.

NOTE – If multiple signal cables need to be connected, ensure that the outer diameters of the signal cables are the same.

Communications Terminal Description

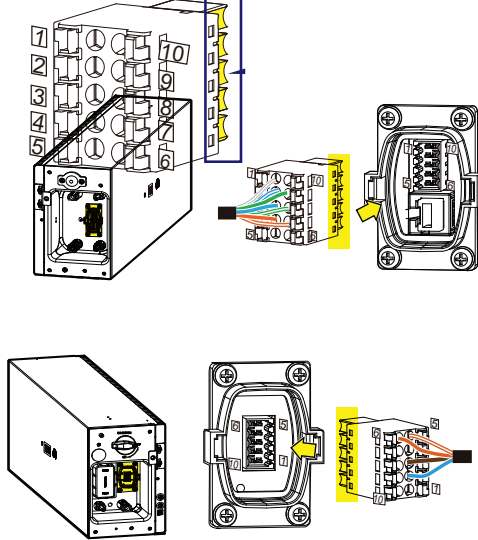

NOTE – It is recommended that the right side of COM port be connected to the inverter and the left side of the COM port be connected to the cascaded batteries. The communications terminal insertion directions on the left and right side of the COM port are different. Insert the communications terminals in the directions shown in the figures.

COM Port Pin Definitions

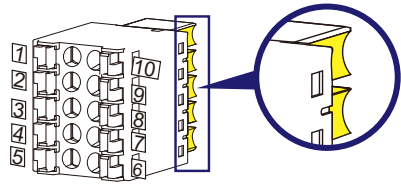

NOTE – The communications terminals on the inverter side need to be connected to RS485+|RS485-, EN+|EN-, and PE. The communications terminals on the cascading side need to be connected to RS485+|RS485-, EN+|EN-, CANH|CANL, and PE.

Nr	Label	Definition	Description
1	PE	Ground point on the shield layer	Ground point on the shield layer
2	Enable-	Enable signal GND	Connects to the enable signal GND of the inverter
3	Enable-	Enable signal+	Connects to the enable signal of the inverter
4	485A	RS485A, RS485 differential signal+	Connects to the RS485 signal port + of the inverter or cascaded batteries.
5			
6	485B	RS485B, RS485 differential signal-	Connects to the RS485 signal port – of the inverter or cascaded batteries.
7			
8	CANL	Extended CAN bus port	Connects to the RS485 signal port – of the inverter or cascaded batteries.
9	CANH	Extended CAN bus port	Used for signal cable cascading in battery cascading scenarios.
10	PE	Ground point on the shield layer	Ground point on the shield layer

Connecting the Communications Terminal to the Inverter

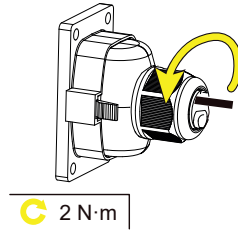
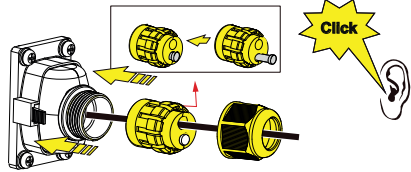
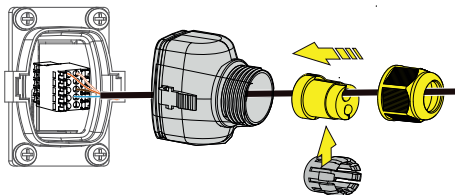
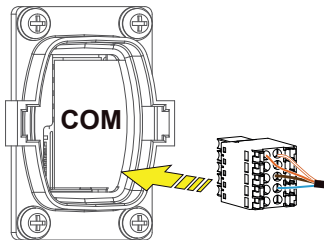
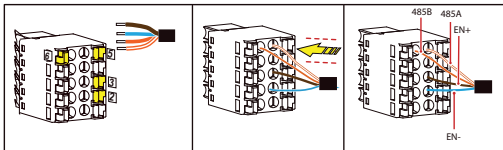
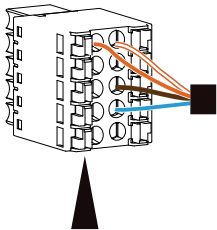
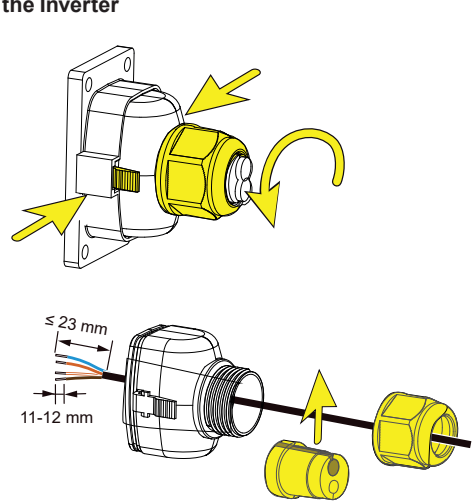

2 N·m

4.6 (Optional) Cable Connections in Cascading Scenarios

Cascading DC Input Connection

Prepare DC connectors and connect DC battery cascading terminals (BAT+ and BAT-) for cascaded batteries. For details, see section 4.4 "Installing DC Input Power Cables."The Staubli MC4 positive and negative metal terminals and DC connectors on the cascading side need to be purchased by customers.

Connecting the Communications Terminal for Cascaded Batteries

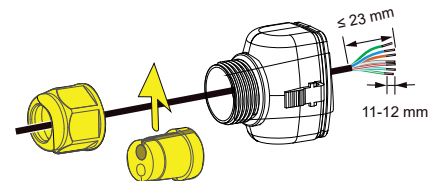
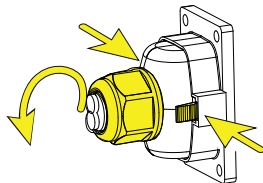

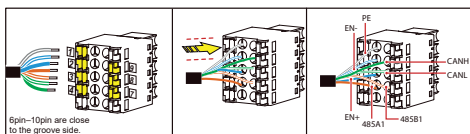
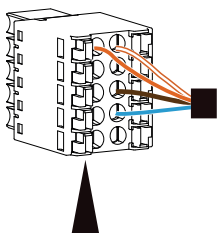

Insert the terminals according to the silkscreen number.

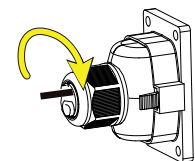
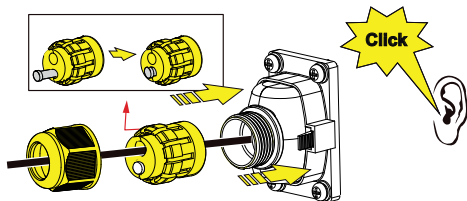
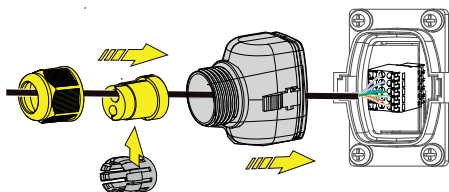
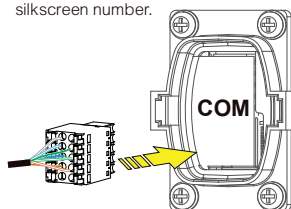

C 2 N·m

NOTE – When a communications terminal is connected to a single network cable, a waterproof rubber plug must be installed.

NOTE – After inserting the terminal shell into the COM port, shake the terminal shell left and right and pull it back to ensure that it is securely installed, and tighten the nut (ensure that the rubber plug is tightly compressed). Otherwise, the waterproof performance is affected.

5. Verifying the Installation

5.1 Installing the Cover

After electrical connections are complete, check that cables are correctly and securely connected, install the external protective cover, and secure it using screws.

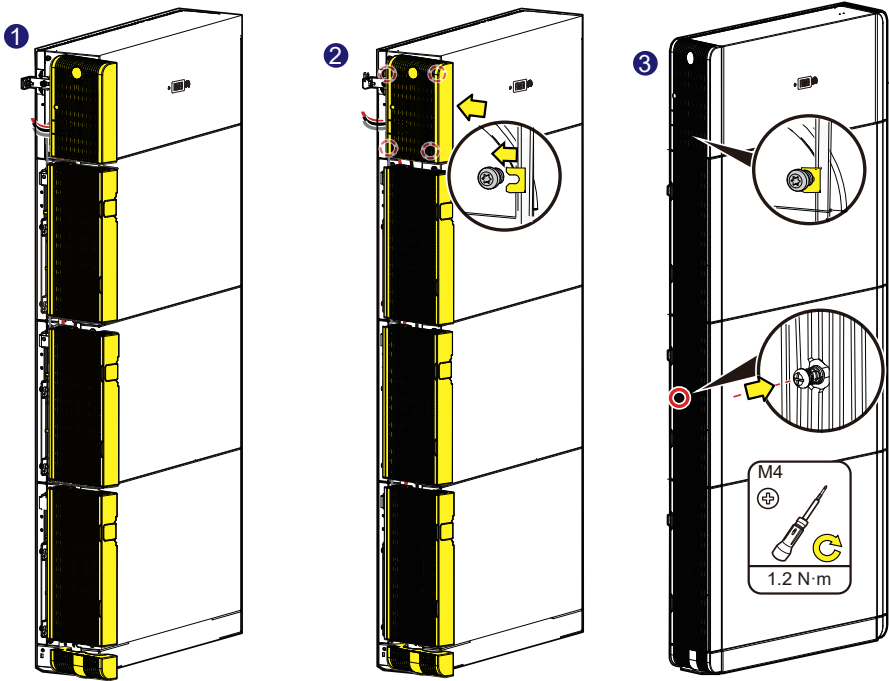



5.2 Verifying the Installation





Nr Acceptance Criterion	
1	The battery is installed correctly and securely.
2	The cables are routed properly as required by the customer
3	Cable ties are secured evenly and no burr exists
4	The ground cable is connected correctly and securely
5	The ground cable is connected correctly and securely.
6	The ground cable is connected correctly and securely.
7	Idle terminals and ports are locked by watertight caps.
8	The installation space is proper, and the installation environment is clean and tidy

6. Power-On Commissioning

6.1 Connecting the Battery Supply

-  **NOTE** – Power on the Battery within 24 hours after unpacking. The power-off time cannot exceed 24 hours during maintenance.
-  **NOTE** – After turning on the battery switch, power on the inverter. For details about how to power on the inverter, see the quick guide for the corresponding inverter model.
-  **NOTE** – If no PV module is configured, press the black start button.

Turn on the DC switch on the battery. After the battery is installed and powered on for the first time, the ring LED blinks for three circles. Observe the battery indicator to check the running status.

Status (Blinking at long intervals: On for 1s and then Off for 1s; Blinking at short Intervals: On for 0.2s and then Off for 0.2s)			
Nr		Meaning	
Running indication		 	N/A
	Steady green	Steady green	Operating mode
	Blinking green at long intervals	Blinking green at long intervals	Standby mode
	OFF	OFF	Sleep mode
	Blinking red at short intervals	N/A	Battery power control module environment alarm
		Blinking red at short intervals	Battery expansion module environment alarm
	Steady red	N/A	Battery power control module fault
	N/A	Steady red	Battery expansion module fault
Battery system indication	 		N/A
	Display green		Indicates battery level. One bar represents 10%.

7. Statement

1. The information in this document is subject to change without notice. Every effort has been made in the preparation of this document to ensure accuracy of the contents, but all statements, information, and recommendations in this document do not constitute a warranty of any kind, express or implied.
2. Before installing the device, read the user manual carefully to get familiar with product information and safety precautions.
3. Only certified electricians are allowed to operate the device. Operation personnel must wear proper personal protective equipment (PPE).
4. The device damage caused by the violation of instructions in this document is not covered under warranty.
5. The cable colors involved in this document are for reference only. Select cables in accordance with local cable specifications.

8. Battery Data Attributes

For detailed battery data attributes, please refer to Battery Energy Storage Solution (BESS) download section from the web: <https://www.fimer.com>.



For more information please contact your local MA Solar Italy representative or visit:

[fimer.com](https://www.fimer.com)

We reserve the right to make technical changes or modify the contents of this document without prior notice. With regard to purchase orders, the agreed particulars shall prevail. MA Solar Italy does not accept any responsibility whatsoever for potential errors or possible lack of information in this document.

We reserve all rights in this document and in the subject matter and illustrations contained therein. Any reproduction, disclosure to third parties or utilization of its contents – in whole or in parts – is forbidden without prior written consent of MA Solar Italy. Copyright© 2025 MA Solar Italy. All rights reserved.